

# CROSSMEMBER

S130 - 280ZX

ITEM 1  
SHCS - 3/8-16 x 3.00", ALLOY  
QTY: 4 PER ASM

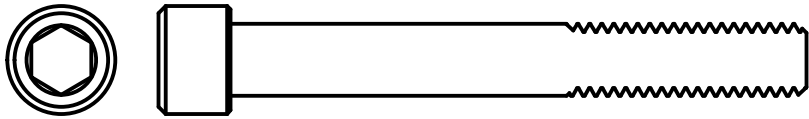

ITEM 2  
WASHER  
3/8, GRADE 8, SAE  
QTY: 4 PER ASM

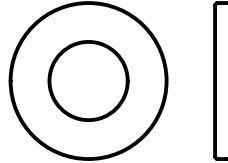

ITEM 3  
NYLON LOCK NUT  
3/8-16, GRADE 8  
QTY: 4 PER ASM

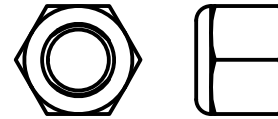

ITEM 4  
WASHER  
9/16, GRADE 8, SAE THICK  
QTY: 6 PER ASM

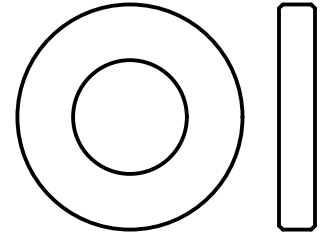

ITEM 5  
HHCS - M14-2.00 x 100mm, 10.9  
QTY: 2 PER ASM

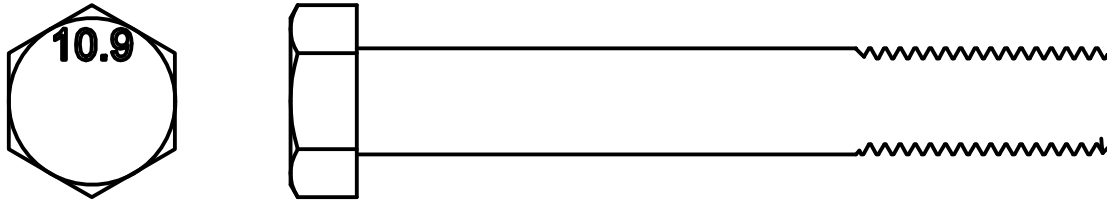

ITEM 6  
SPACER-4 14mm SPACER  
QTY: 4 PER ASM

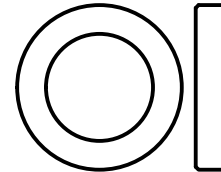

ITEM 7  
NYLON LOCK NUT  
M14-2.00, 10.9  
QTY: 2 PER ASM

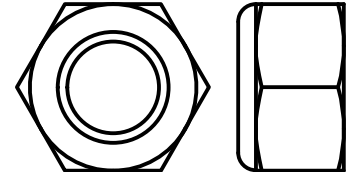

## ASSEMBLED / INCLUDED ITEMS

ITEM 8 S130 - LOWER RACK CLAMP  
QTY: 2 PER ASM

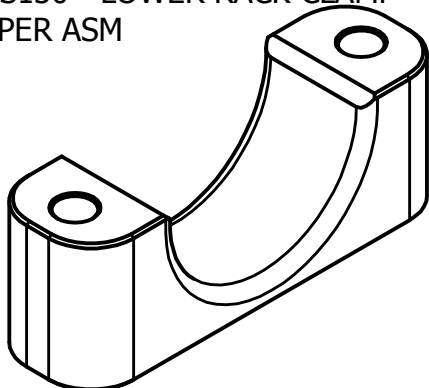

ITEM 9 S130 - UPPER RACK CLAMP  
QTY: 2 PER ASM

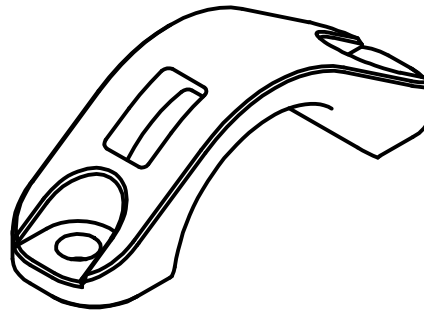

ITEM 10 S130 - RACK CLAMP SPACER  
QTY: 4 PER ASM

